



Manual v.2.1

Kelly Cumberland

The output is an artist's book, or 'printed exhibition', that reflects Cumberland's on-going engagement with artists and gallerists in Palma de Mallorca.

Research process

Central to Cumberland's research practice is an investigation into the nature of a serial body of work, the complex relationships between repetition, reproduction and difference and its manifestations as expanded drawing practice. The process of making and documenting exhibitions leads to the development of strategies of dissemination, extending the reach of a body of work, and making new connections.

Research Insights

The on-going project with artists and gallerists in Palma de Mallorca involving a series of exhibitions and publications enables Cumberland to continue to explore what a drawing could be when it is reproduced, reformatted and remade. Experimentation and investigation with the documentation and representation of Cumberland's expanded drawing practices, explores a series of works through the print and the publishing field. Thus, the boundary between art piece and catalogue begins to collapse. The printed exhibition in its design, layout and image selection, co-exist to provide relevant exhibition information whilst also contributing as an artwork in its own right. The exhibition is an immediate experience whilst the printed exhibition exists as a longstanding memory over time. This episodic process enables the artist to renew, re-consider, rework and re-engage with the possibilities of expanded drawing practices as part of the cycle of making.

Dissemination

The publication was disseminated via Aba Art Lab Gallery as part of Art Palma Brunch, April 2016.



MANUAL v.2.1
 [MANUAL v.2.0]
 Dibuix per la Plaça Porta de Santa Catalina
 ABA ART LAB
 Nit de l'Art Palma 2015

Kelly Cumberland & Michael James Walker

Numbered Edition

38 / 100



MANUAL v.1.0 Nit de l'Art Palma 2013
 Sant Feliu 2



MANUAL v.1.1 [numbered edition - 150]
 Art Palma Brunch 2015



MANUAL v.2.0 Nit de l'Art Palma 2015
 ABA ART LAB
 Dibuix per la Plaça Porta de Santa Catalina

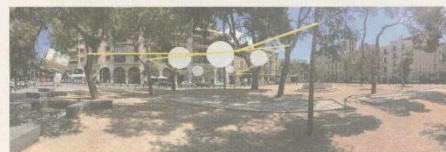
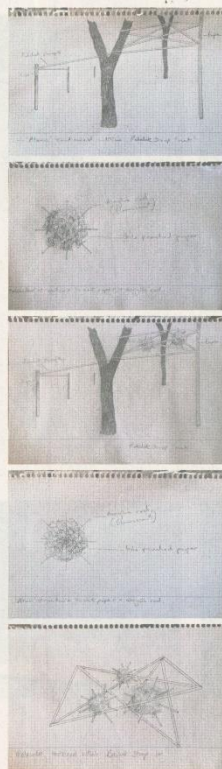

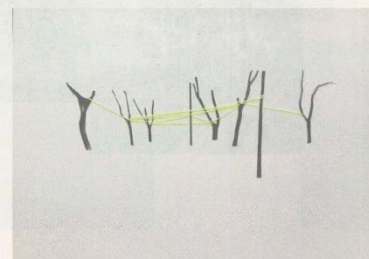
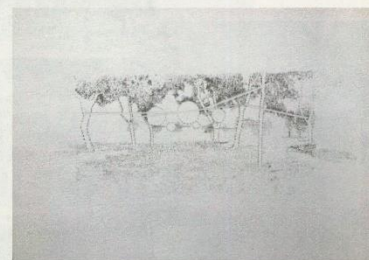
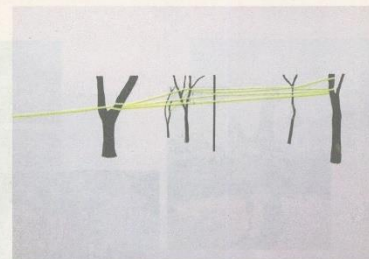
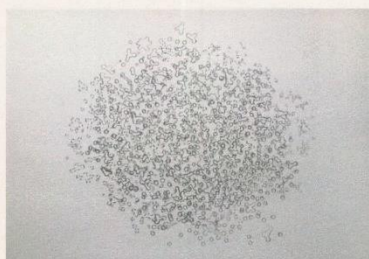
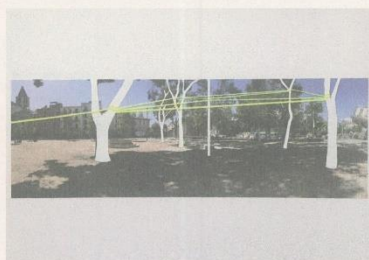
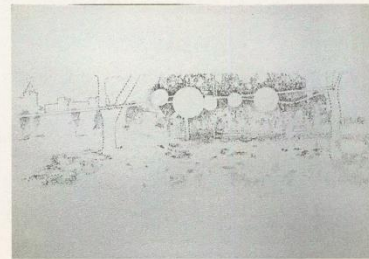
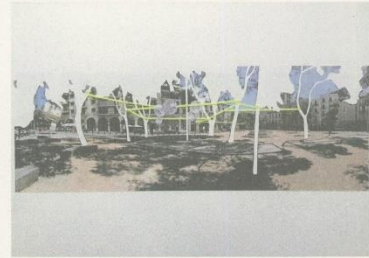
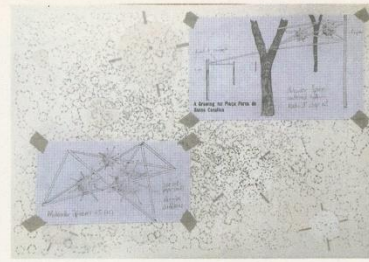
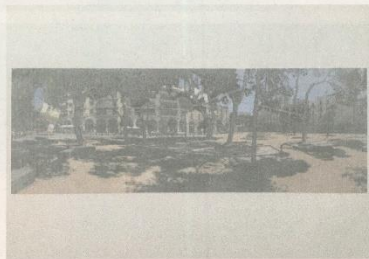
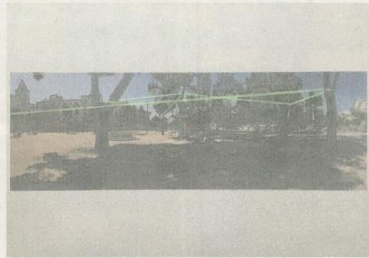
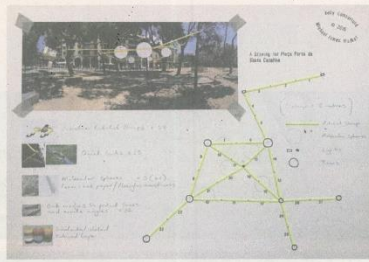





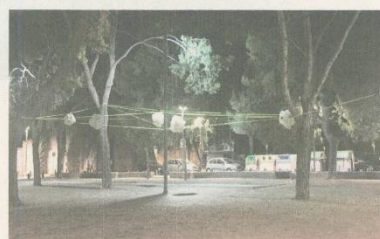
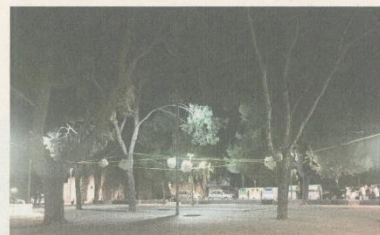
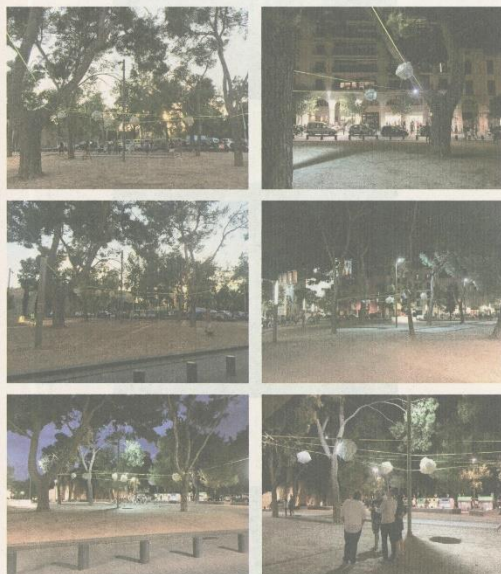



- Kelly Cumberland & Michael James Walker

- MANUAL v.2.1 [numbered edition - 100] 2016

- MANUAL v.2.0 Nit de l'Art Palma 2015
ABA ART LAB
Dibuix per la Plaça Porta de Santa Catalina

- MANUAL v.1.1 [numbered edition - 150] 2015

- MANUAL v.1.0 Nit de l'Art Palma 2013
Sant Feliu 2

- © MANUAL and the artists 2016
All rights reserved

- email: kc@kellycumberland.com / mijawa@icloud.com / manualversion@gmail.com
- instagram: kelly_cumberland / michaeljameswalker
- twitter: @kellycumberland / @mijawa / @MANUAL_version
- web: kellycumberland.com / walkerhill.org / manual.gallery

- with thanks to
Maribel, Alejandra and their team at ABA ART LAB

- ABA ART LAB
Plaça Porta de Santa Catalina 21b
07012 Palma de Mallorca

- t/f: 971 717 835 - 656 965 423
- Hours: Mon - Sat 11-4 / 17-20

- www.abaart.com - info@abaart.com
- facebook.com/aba.contemporani - instagram.com/abaartlab

NIT DE
L'ART
'15

DISSABTE
19/09
19.00 H

ART|PALMA®

AIGAB

ABA ART LAB

Dibuix per la Plaça Porta de Santa Catalina

Kelly Cumberland & Michael James Walker

supported by

ABA
ART
LAB



Newspaper  Club